

Product Specification & Parts Listing

BLIZZARD

The Blizzard is a free standing, mains pressure water dispenser designed for rugged conditions. It provides the most modern designs and materials available, and is engineered to the highest level of quality and dependability.



MODEL: BLIZZARD 100-115VAC Standard Cooler Specifications and Performance Data

ITEM		SPECIFICATIONS
POWER RATING		SINGLE PHASE
		100-115VAC 60Hz
STANDARD CURRENT		2.7A
POWER CONSUMPTION	COLD	189W
	HOT	--
COLD	COMPRESSOR	AE1360Y-1
	REFRIGERANT	R-134a(200g)
	TEMP RANGE	4-10°C(39.2-50°F)
	TEMP. CONTROL	Wp4
HOT	HEATER	--
	TEMP RANGE	--
	SAFETY DEVICE	--
	TEMP CONTROL	--
NOISE(SOUND POWER LEVEL)		64dB (A)
NET WEIGHT		COLD ONLY: 28kg (61.7 lb)
DIMENSION		410 (W) x 410(D) x 1180(H)mm

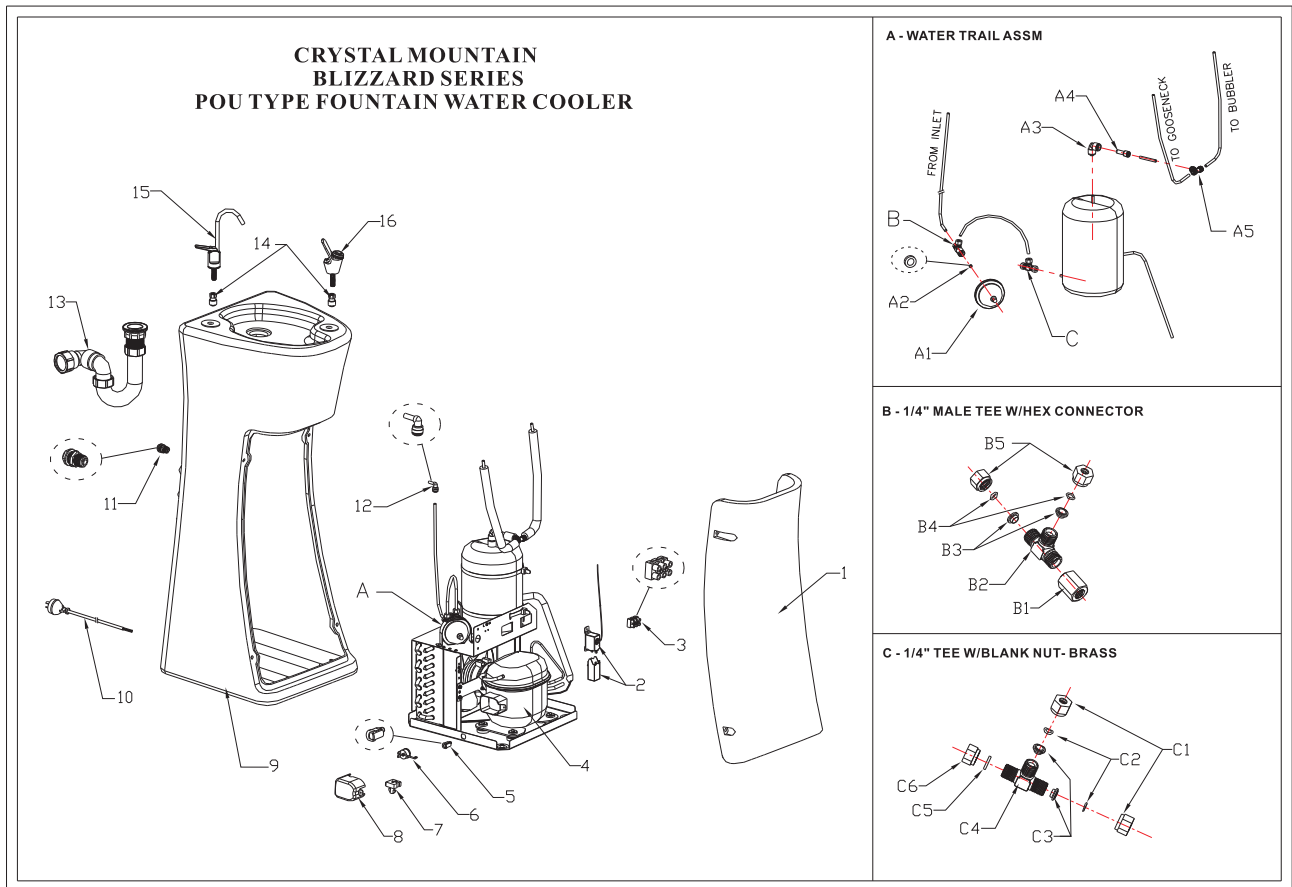

**CRYSTAL MOUNTAIN
BLIZZARD SERIES POU FOUNTAIN COOLER**

No.	DESCRIPTION	PART CODE	No.	DESCRIPTION	PART CODE
MAIN ASSEMBLY			A WATER TRAIL ASSM		
1	BLIZZARD FRONT PANEL - GRANITE	PLC-C100184	A1	SHOCK ARRESTER 1/4 BSP MALE	POU-C100001
2	COLD CONTROL	REF-C100070	A2	GASKET-TEE TO EXPAN CHAMBER	SIL-C100054
3	3 PIN TERMINAL BLOCK	ELE-C100095	A3	1/4 SUPERSEAL X 3/8 ELBOW JG	POU-C100002
4	REFRIGERATION SYSTEM ASSEMBLY	N/A	A4	JG-1/4" F-3/8" M STRAIGHT REDUCE	POU-C100015
5	STRAIN RELIEF (POWER CORD)	MIS-C100061	A5	JG-1/4" EQUAL FITTING	POU-C100012
6	110V CUTOUT - KK 1370Y	REF-C100113	B 1/4" MALE TEE W/HEX CONNECTOR		
7	110V RELAY - KK 1370Y	REF-C100114	B1	1/4" BSP HEX CONNECTOR	BRS-C100008
8	COMPRESSOR COVER - KK 1370Y	REF-C100110	B2	1/4" EQUAL TEE-BRASS	BRS-C100001
9	BLIZZARD BODY GRANITE	PLC-C100175	B3	1/4" COMPRESSION RING-BRASS	BRS-C100004
10	N/A POWER CORD-NO IEC	ELE-C100114	B4	6MM O-RING-BRASS FITTING	SIL-C100050
11	BULKHEAD FITTING JG 1/4 BY 1/4	POU-C000002	B5	1/4" COMPRESSION NUT-BRASS	BRS-C100005
12	JG 1/4X1/4 STEM ELBOW	POU-C100027	C 1/4" TEE W/BLANK NUT-BRASS		
13a	THREADED DRAIN COLLAR(SS)	POU-C100032	C1	1/4" COMPRESSION NUT-BRASS	BRS-C100005
13b	40MM S&P TRAP	POU-C100031	C2	6MM O-RING-BRASS FITTING	SIL-C100050
14	FITTING-1/4" X 7/16UNS	POU-C100030	C3	1/4" COMPRESSION RING-BRASS	BRS-C100004
15	GOOSENECK FAUCET	POU-C100025	C4	1/4" EQUAL TEE-BRASS	BRS-C100001
16	WATER BUBBLER	POU-C100033	C5	GASKET FOR BRASS DRAIN CAP	SIL-C100085
			C6	BLANKING END 1/4" BRASS	BRS-C100002